

**NOTE COMPLETION**

We have the main idea given to us, so we can use keywords.

# Test 1

## LISTENING

### PART 1 Questions 1–10

Complete the notes below.

Write **ONE WORD AND/OR A NUMBER** for each answer.

### Children's Engineering Workshops

#### Tiny Engineers (ages 4–5)

##### Activities

- Create a cover for an 1 ..... so they can drop it from a height without breaking it.
- Take part in a competition to build the tallest 2 .....
- Make a 3 ..... powered by a balloon.

#### Junior Engineers (ages 6–8)

##### Activities:

- Build model cars, trucks and 4 ..... and learn how to program them so they can move.
- Take part in a competition to build the longest 5 ..... using card and wood.
- Create a short 6 ..... with special software.
- Build, 7 ..... and program a humanoid robot.

Cost for a five-week block: £50

Held on 8 ..... from 10 am to 11 am

#### Location

Building 10A, 9 ..... Industrial Estate, Grasford

Plenty of 10 ..... is available.



**PART 2      Questions 11–20***Questions 11–14*

Choose the correct letter, **A**, **B** or **C**.

- 11** Stevenson's was founded in
- A** 1923.
  - B** 1924.
  - C** 1926.
- 12** Originally, Stevenson's manufactured goods for
- A** the healthcare industry.
  - B** the automotive industry.
  - C** the machine tools industry.
- 13** What does the speaker say about the company premises?
- A** The company has recently moved.
  - B** The company has no plans to move.
  - C** The company is going to move shortly.
- 14** The programme for the work experience group includes
- A** time to do research.
  - B** meetings with a teacher.
  - C** talks by staff.

**DIAGRAM COMPLETION (MAP)**

Test 1

Questions 15–20

Label the map below.

Write the correct letter, **A–J**, next to Questions 15–20.

**Plan of Stevenson's site**

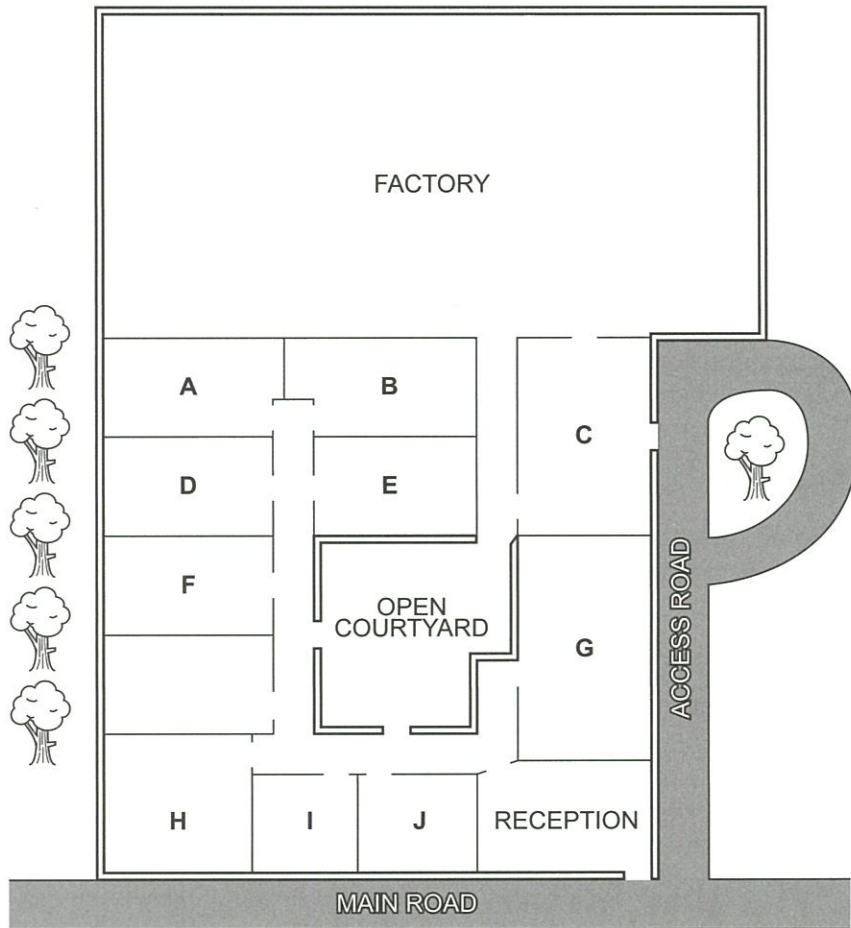

- 15 coffee room .....
- 16 warehouse .....
- 17 staff canteen .....
- 18 meeting room .....
- 19 human resources .....
- 20 boardroom .....

**PART 3      Questions 21–30**

*Questions 21 and 22*

Choose **TWO** letters, **A–E**.

Which **TWO** parts of the introductory stage to their art projects do Jess and Tom agree were useful?

- A** the Bird Park visit
- B** the workshop sessions
- C** the Natural History Museum visit
- D** the projects done in previous years
- E** the handouts with research sources

*Questions 23 and 24*

Choose **TWO** letters, **A–E**.

In which **TWO** ways do both Jess and Tom decide to change their proposals?

- A** by giving a rationale for their action plans
- B** by being less specific about the outcome
- C** by adding a video diary presentation
- D** by providing a timeline and a mind map
- E** by making their notes more evaluative

Questions 25–30

Which personal meaning do the students decide to give to each of the following pictures?

Choose **SIX** answers from the box and write the correct letter, **A–H**, next to Questions 25–30.

- | Personal meanings |                               |
|-------------------|-------------------------------|
| <b>A</b>          | a childhood memory            |
| <b>B</b>          | hope for the future           |
| <b>C</b>          | fast movement                 |
| <b>D</b>          | a potential threat            |
| <b>E</b>          | the power of colour           |
| <b>F</b>          | the continuity of life        |
| <b>G</b>          | protection of nature          |
| <b>H</b>          | a confused attitude to nature |

**Pictures**

- |           |                                |       |
|-----------|--------------------------------|-------|
| <b>25</b> | Falcon (Landseer)              | ..... |
| <b>26</b> | Fish hawk (Audubon)            | ..... |
| <b>27</b> | Kingfisher (van Gogh)          | ..... |
| <b>28</b> | Portrait of William Wells      | ..... |
| <b>29</b> | Vairumati (Gauguin)            | ..... |
| <b>30</b> | Portrait of Giovanni de Medici | ..... |

**PART 4 Questions 31–40**

Complete the notes below.

Write **ONE WORD ONLY** for each answer.

### Stoicism

Stoicism is still relevant today because of its **31** ..... appeal.

#### Ancient Stoics

- Stoicism was founded over 2,000 years ago in Greece.
- The Stoics' ideas are surprisingly well known, despite not being intended for **32** .....

#### Stoic principles

- Happiness could be achieved by leading a virtuous life.
- Controlling emotions was essential.
- Epictetus said that external events cannot be controlled but the **33** ..... people make in response can be controlled.
- A Stoic is someone who has a different view on experiences which others would consider as **34** .....

#### The influence of Stoicism

- George Washington organised a **35** ..... about Cato to motivate his men.
- The French artist Delacroix was a Stoic.
- Adam Smith's ideas on **36** ..... were influenced by Stoicism.
- Some of today's political leaders are inspired by the Stoics.
- Cognitive Behaviour Therapy (CBT)
  - the treatment for **37** ..... is based on ideas from Stoicism
  - people learn to base their thinking on **38** .....
- In business, people benefit from Stoicism by identifying obstacles as **39** .....

#### Relevance of Stoicism

- It requires a lot of **40** ..... but Stoicism can help people to lead a good life.
- It teaches people that having a strong character is more important than anything else.